



MAIMOON

G A R D E N S

BY



Fakhruddin
Properties



A N E W S H A D E T O L I F E

WHY INVEST IN DUBAI?



STRONG RESURGENCE OF THE ECONOMY

Promising growth
after pandemic



HIGH SAFETY

One of the safest
city to live in



EXPO CITY

An exciting new
sustainability hub



EXCELLENT INFRASTRUCTURE

Ranks among the
best in the world



HIGH ROI

Rental and value
appreciation



UNMATCHED REAL ESTATE PROJECTS

Architectural marvel
of the modern world

DUBAI ATTRACTIONS



BURJ
AL ARAB



THE PALM
JUMEIRAH



ATLANTIS,
DUBAI



MIRACLE
GARDEN



BURJ
KHALIFA



LA MER
BEACH



AIN
DUBAI



DUBAI
MALL



MUSEUM OF
THE FUTURE



DUBAI
FRAME



DUBAI
SAFARI PARK



MALL OF
THE EMIRATES

OUR LEGACY

The legacy of **Fakhruddin Holdings** in Dubai dates back to 1963 when **Mr. Fakhruddin Ibrahimji Al Hindi** established the first business in Murshid Bazaar, Deira. After successfully consolidating the business for years, it began diversification with its venture into **Sterling Parfums, Premier Cosmetics** and **Premier Plastics** in the early 2000s.

Since 2003, under the brand of **Fakhruddin Properties**, we have developed a diverse international portfolio of residential and commercial properties. We continue to deliver real estate with the aim to provide sustainable and innovative spaces.



Fakhruddin
HOLDINGS

OUR BRAND STORY

Fakhruddin Properties was formed in 2003. Since its inception, **Fakhruddin Holdings** has marked its presence with developments in several noteworthy projects encompassing many upcoming communities of Dubai from International city and Dubai Silicon Oasis to posh and premium locations such as Business Bay and Jumeirah Village Circle.

Headquartered at Lake Central Tower, at the heart of Business Bay Dubai, Fakhruddin properties have also forayed into international markets of Africa and the United Kingdom.



Fakhruddin
Properties



 **MAIMOON**
GARDENS

THE PERFECT BLEND OF
AFFORDABILITY AND
SUSTAINABILITY

LOCATION
MAP





STATE-OF-THE-ART AMENITIES

-  CLEAN AIR
-  LATEST WATER TECH
-  SMART HOMES
-  ORGANIC GREENHOUSE
-  GREEN WALL
-  WASTE MANAGEMENT
-  YOGA/MEDITATION & ZEN GARDEN
-  EV STATION
-  CALISTHENICS
-  BADMINTON COURT
-  PADEL TENNIS COURT
-  SQUASH COURT
-  TABLE TENNIS
-  HEALTH CLUB
-  STEAM & SAUNA
-  KIDS PLAY AREA
-  BARBEQUE AREA
-  MIST LOUNGE
-  CASCADING WATERFALL
-  LAZY RIVER
-  SWIMMING POOL



HOME WITH THE CLEANEST AIR IN UAE

- Continuously Monitored And Controlled Pure Air
- Energy Efficient Cooling Solution

SAVINGS OF UP TO 40%

Powered by



* For illustrative purposes only.

airocide®

DEVELOPED FOR NASA

CUTTING EDGE AIR PURIFICATION TECHNOLOGY DEVELOPED FOR NASA



* For illustrative purposes only.



CENTRALIZED RO WATER PURIFICATION SYSTEM

Reduce plastic usage and pollution cause due to transport



SAVINGS ON WATER OF UP TO 300%

* For illustrative purposes only.



EV CHARGING STATIONS



* For illustrative purposes only.



AUTOMATED SMART HOMES

➤ Reduce your Carbon footprint

ENERGY SAVINGS OF **UP TO 30%**

* For illustrative purposes only.

WASTE DISPOSAL SYSTEM

Dry and Wet waste management for
composting and other recyclable materials

* For illustrative purposes only.





GREEN HOUSE & WELLNESS LOUNGE

Grow your own organic veggies

* For illustrative purposes only.



YOUR OWN PERSONALISED HERB GARDEN

Grow your own organic herbs

* For illustrative purposes only.



YOGA & MEDITATION GARDEN

Find your calm and peace at our exceptionally crafted gardens



* For illustrative purposes only



ZEN GARDEN



* For illustrative purposes only



Unwind at the one of its kind Amenity rich outdoor podium

KIDS PLAY
AREA

* For illustrative purposes only.



BARBEQUE
AREA

* For illustrative purposes only.



TABLE TENNIS

Indulge in games with your friends and family



PADEL TENNIS COURT



BADMINTON COURT



For illustrative purposes only.

SQUASH COURT



* For illustrative purposes only.



CALISTHENICS PARK

Boost your Fitness at State-of-the-art Health Club and Outdoor Calisthenics



* For illustrative purposes only.



HEALTH CLUB

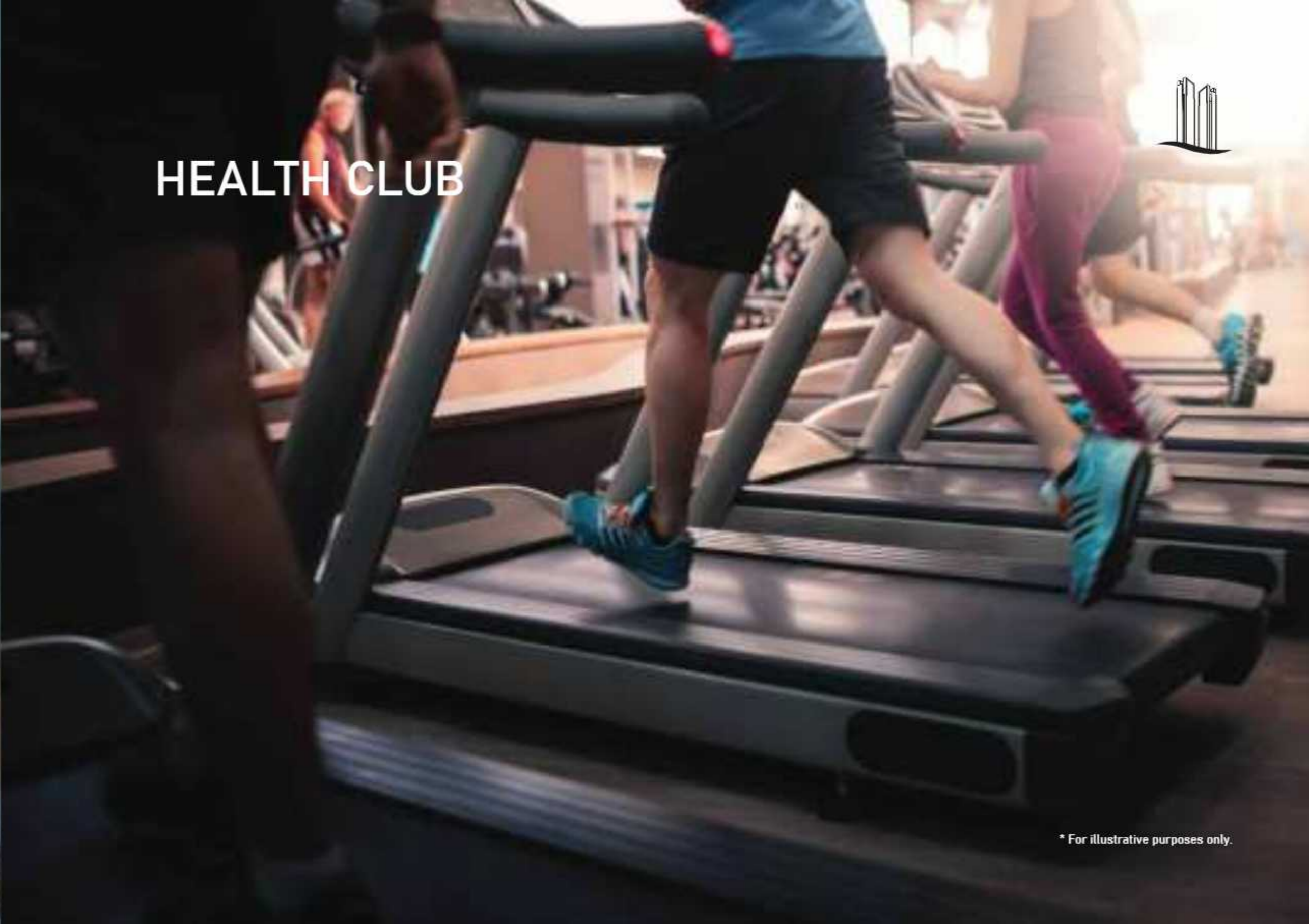

* For illustrative purposes only.



SAUNA



KIDS
POOL



STEAM



* For illustrative purposes only.

* For illustrative purposes only.

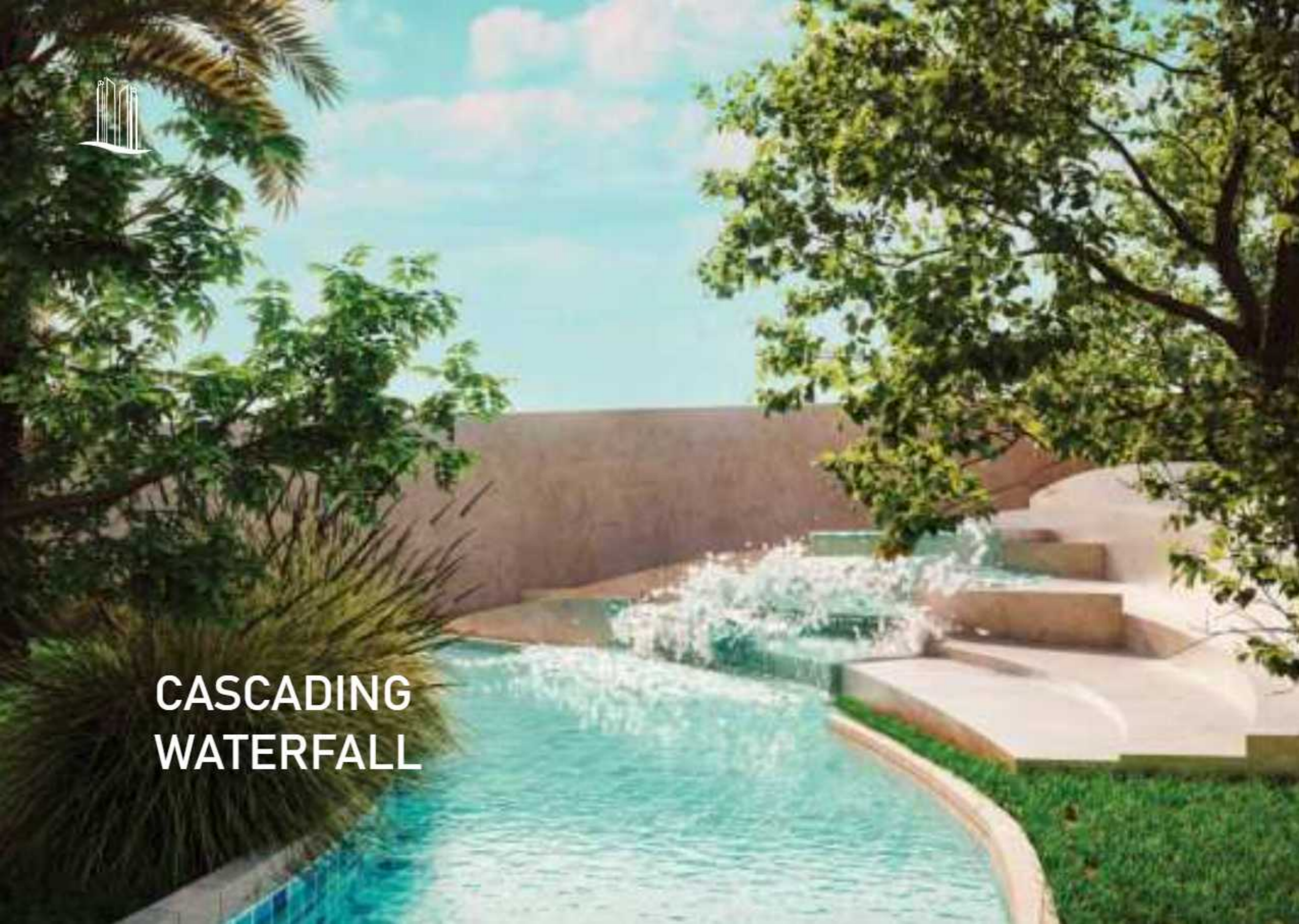

**CASCADING
WATERFALL**



LAZY RIVER

* For illustrative purposes only.

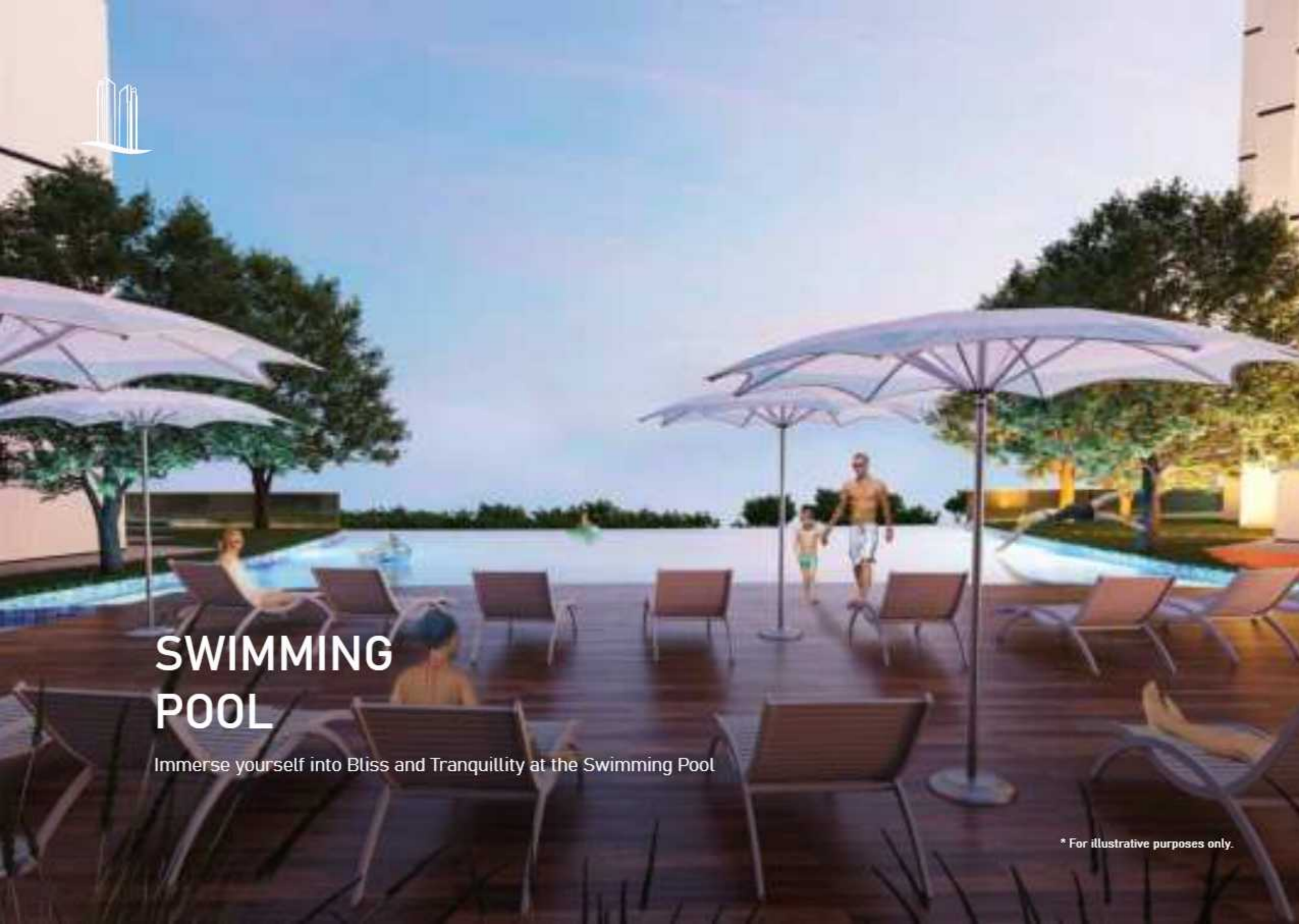

SWIMMING POOL

Immerse yourself into Bliss and Tranquility at the Swimming Pool

* For illustrative purposes only.

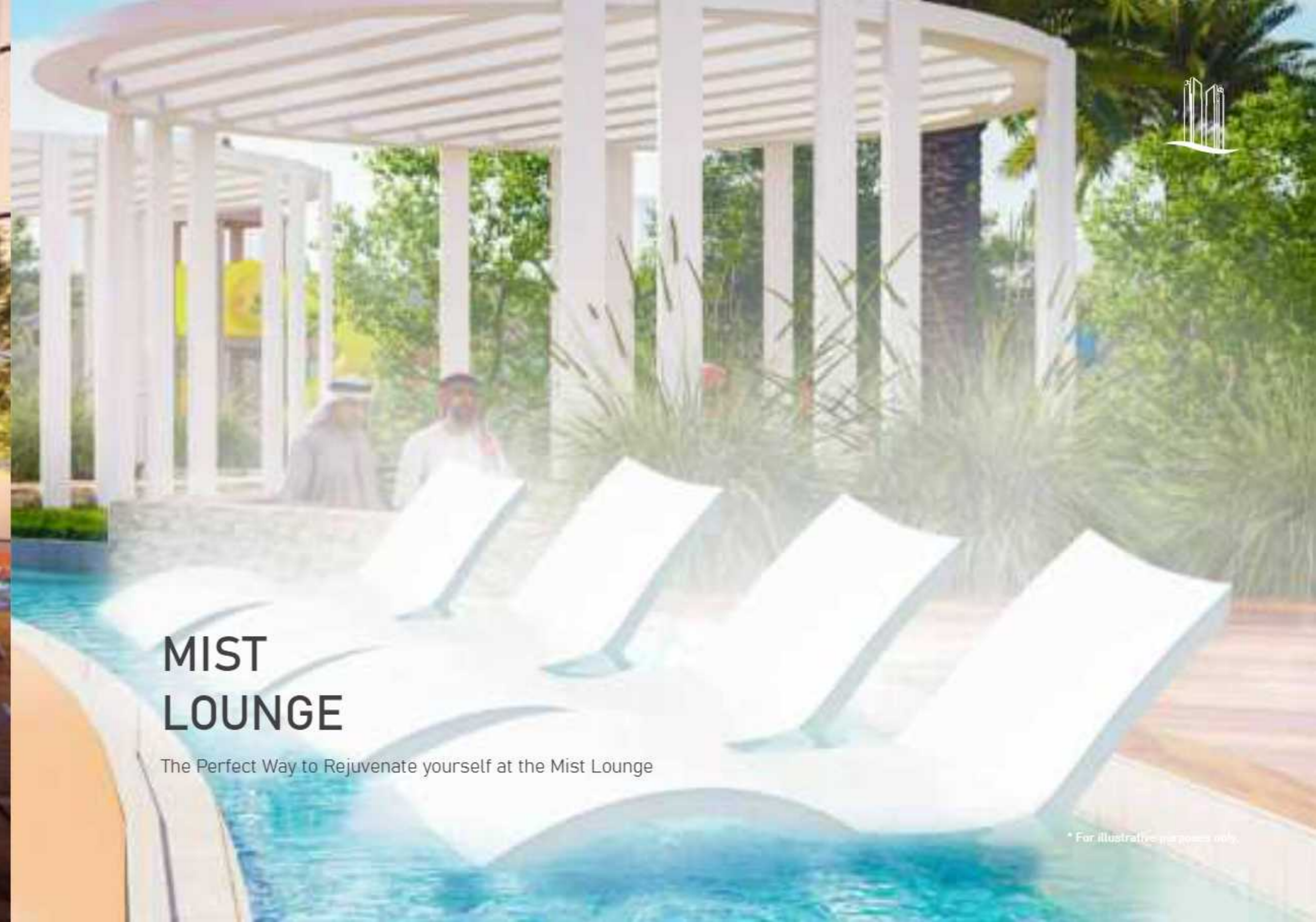

MIST LOUNGE

The Perfect Way to Rejuvenate yourself at the Mist Lounge

* For illustrative purposes only.



STUDIO - TYPE 1A
37.06 sq. m
(399 sq. ft)

Disclaimer: All design, features, amenities, materials, dimensions, and layout drawings are approximate and subject to change without prior notice. The actual area of the Unit may vary from the stated area; drawings are not to scale. The developer reserves the right to make revisions to comply with any Applicable Law or the requirements of any Relevant Authority. For exact sizes please refer to the Unit Purchase Agreement.



STUDIO - TYPE 1B
36.04 sq. m
(388 sq. ft)

Disclaimer: All design, features, amenities, materials, dimensions, and layout drawings are approximate and subject to change without prior notice. The actual area of the Unit may vary from the stated area; drawings are not to scale. The developer reserves the right to make revisions to comply with any Applicable Law or the requirements of any Relevant Authority. For exact sizes please refer to the Unit Purchase Agreement.



1 BED - Type 1

55.74 sq. m
(600 sq. ft)

Disclaimer: All design, features, amenities, materials, dimensions, and layout drawings are approximate and subject to change without prior notice. The actual area of the Unit may vary from the stated area; drawings are not to scale. The developer reserves the right to make revisions to comply with any Applicable Law or the requirements of any Relevant Authority. For exact sizes please refer to the Unit Purchase Agreement.



2 BED - Type 1

89.83 sq. m
(967 sq. ft)

Disclaimer: All design, features, amenities, materials, dimensions, and layout drawings are approximate and subject to change without prior notice. The actual area of the Unit may vary from the stated area; drawings are not to scale. The developer reserves the right to make revisions to comply with any Applicable Law or the requirements of any Relevant Authority. For exact sizes please refer to the Unit Purchase Agreement.

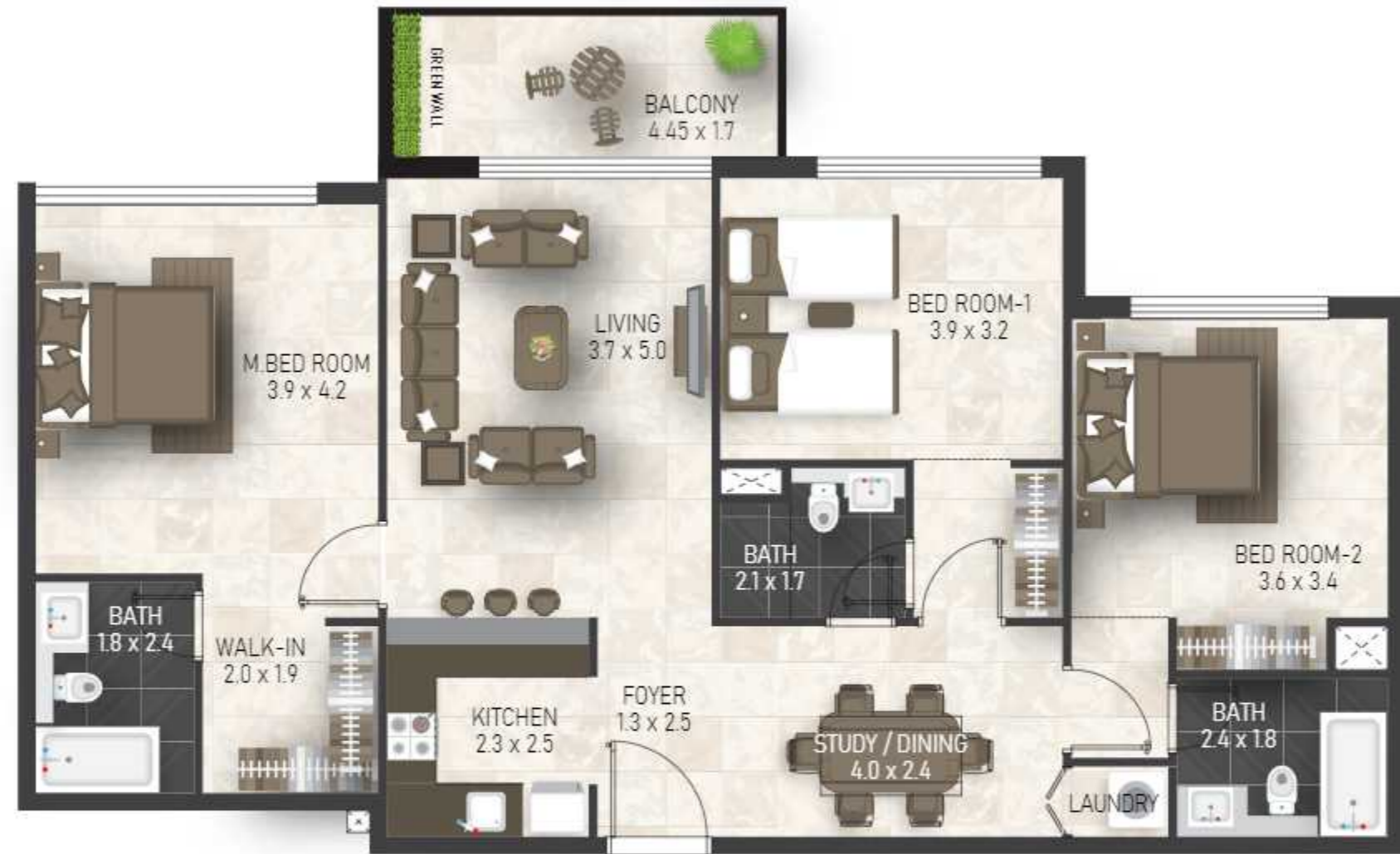

3 BED - Type 1A

118.54 sq. m
(1,276 sq. ft)

Disclaimer: All design, features, amenities, materials, dimensions, and layout drawings are approximate and subject to change without prior notice. The actual area of the Unit may vary from the stated area; drawings are not to scale. The developer reserves the right to make revisions to comply with any Applicable Law or the requirements of any Relevant Authority. For exact sizes please refer to the Unit Purchase Agreement.



3 BED - Type 1B

118.35 sq. m
(1,274 sq. ft)

Disclaimer: All design, features, amenities, materials, dimensions, and layout drawings are approximate and subject to change without prior notice. The actual area of the Unit may vary from the stated area; drawings are not to scale. The developer reserves the right to make revisions to comply with any Applicable Law or the requirements of any Relevant Authority. For exact sizes please refer to the Unit Purchase Agreement.

PROMISE OF A GREENER FUTURE

We at Fakhruddin Properties, are committed to your wellbeing and aim to create healthier living spaces. We understand that environment-friendly and sustainable development is crucial now as we spend more time at our homes. So we work towards our goal to build the finest quality homes for the future.

We know that our consistent efforts to develop and incorporate sustainable green technologies will have a far-reaching impact on the lives and wellbeing of our clients and the environment at large. We work passionately to deliver beautifully designed, sustainable and affordable homes on time to match your expectations.

We appreciate and value your trust and believe that your happiness is our true measure of success.



BY

