

ORLA
INFINITY

) (*Dorchester Collection*

DUBAI

OMNIYAT



WELCOME TO THE

INFINITE

ORLA Infinity represents the latest masterpiece by OMNIYAT. It is a destination for open minded individuals seeking resort-style living as part of everyday life, seamlessly blending with the surrounding sand and sea to exude a sense of tranquility.

With only 20 duplex residences, ORLA Infinity presents an exclusive and personalized experience. Each residence is thoughtfully positioned and designed to integrate indoor and outdoor spaces, allowing for breathtaking views of the surrounding facilities and the cityscape beyond.

ORLA

INFINITY

Dorchester Collection

DUBAI





RELAXATION IN EVERY RESIDENCE

Elevate your everyday and experience refined sophistication. With impeccable style, ORLA Infinity allows you to indulge in the finer things that surround you. Discover a life that is truly extraordinary at its core.

Each residence is a beachfront paradise, complete with a private infinity pool where relaxation knows no bounds.



A WORLD OF INFINITE POSSIBILITIES

At the heart of this masterpiece lies the visionary architecture sculpted by Foster + Partners, a testament to their mastery of design. Complementing this, the management prowess of the global hospitality icon, Dorchester Collection, ensures an outstanding standard of living. Luxuriate in private duplex residences with Yodezeen's

stunning interiors, creating an ambiance that resonates with your aspirations.

Beyond your doorstep, a world of beauty awaits, embraced by the artistry of Zed Collective's landscaping. Sweeping views unfold, inspiring awe and connecting you to the environment in profound ways.

ORLA
INFINITY

)(*Dorchester Collection*
DUBAI

ORLA

)(*Dorchester Collection*
DUBAI



Introducing ORLA and ORLA Infinity, two distinct, exclusive residences that form a singular, exclusive destination, sharing world class amenities.

ORLA exudes refined elegance, providing an oasis of tranquility, while ORLA Infinity offers unparalleled privacy. Together, they harmoniously enrich the lives of discerning individuals, redefining resort-style living within one ultra-luxury residential community.



AT THE APEX OF AN ICON, PALM JUMEIRAH

Palm Jumeirah is an exclusive destination intimately connected to the sea, offering unparalleled beauty.

Nearby, you'll discover Dubai's finest restaurants, clubs, and beach resorts, providing a world-class experience.

The wonders of Dubai are easily accessible, ensuring that every captivating sight is within your reach.

Situated on a 16,600 sq.m. beachfront plot at the apex of the Palm's crescent, this prime position offers

uninterrupted 270° views, encompassing Dubai's stunning skyline and the turquoise waters of the Arabian Gulf.

A modern, curved glass building at night. The building features a prominent curved glass facade on the left side, revealing an interior with a chandelier and office furniture. The building is situated on a rooftop terrace with a glass railing. The terrace is furnished with a dining table and chairs, and several potted plants. In the background, a city skyline is visible at night, with numerous illuminated buildings and a body of water in the foreground. The sky is a deep blue, and the overall atmosphere is sophisticated and modern.

G L O B A L
P I O N E E R S



ARCHITECTURE AT ITS FINEST: FOSTER + PARTNERS

With a legacy spanning over 50 years, Foster + Partners, an internationally renowned architectural practice, has continuously set the standard for innovative design and sustainable engineering worldwide. At ORLA Infinity, their expertise is exemplified.

With breathtaking views of the Arabian Gulf on one side and the iconic Palm Jumeirah and Dubai's distinctive skyline on the other, this architecturally distinguished masterpiece is perfectly attuned to the most discerning lifestyles.



INTERIOR DESIGN VISIONARIES: YODEZEEN

Recognized by their industry with numerous awards, Yodezeen lends their distinct vision to the spacious rooms and public areas of ORLA Infinity. With exquisite craftsmanship, their celebrated interiors combine colours, textures, and materials, creating an inviting environment for stylish living.



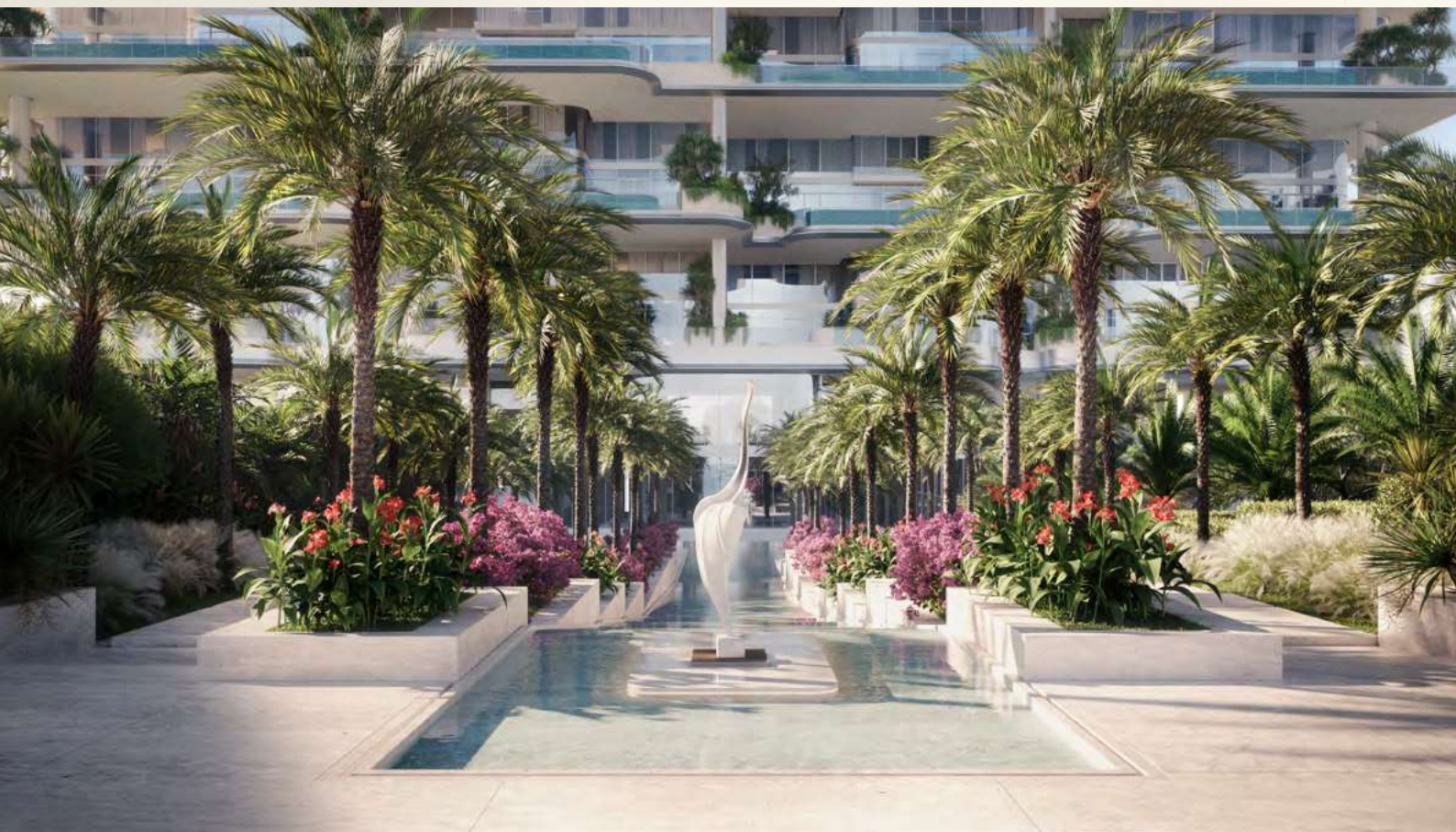

LANDSCAPE ARCHITECTS: ZED COLLECTIVE

Creating a fitting environment for a prestigious development like ORLA Infinity requires the expertise of a skilled Balinese landscape architect.

ZED Collective, recognized worldwide for their designs that prioritize people and the environment, have crafted a captivating ecosystem. Unifying intimate gardens and open spaces, their thoughtful design offers panoramic views that extend beyond delicate acacias, olives, and palms, encompassing the iconic Dubai skyline and beyond.



EXCELLENCE
ON ARRIVAL



AN ARRIVAL LIKE NO OTHER

A landscaped driveway grants you access to a private entrance, welcoming you to ORLA Infinity. As you step into the ground floor lobby, a world-class service awaits, accompanied by exquisite artworks and flowing water features that amplify the grandeur of the space.

Discreet lifts effortlessly transport you from either the secure parking garage or ground floor directly to your residence, ensuring privacy and convenience.



TWENTY
DISTINGUISHED
DUPLIX
RESIDENCES

pierre cardin
JACQUES HALLER & CHANEL
TOM FORD



Step into your residence through direct lift access, where you'll be greeted by an exquisite sense of spaciousness and serenity, from the double-height ceilings.

This remarkable ambiance is further enhanced by the meticulously crafted frames

adorning the floor-to-ceiling windows, which provide uninterrupted panoramic views of the stunning Gulf and the iconic Palm Jumeirah, creating a truly captivating living experience.



Within each residence, the rooms combine the finest materials with intuitive design, curated to perfection. Complemented by smart home automation, the living experience becomes effortlessly simple and integrated.

Indulge in the luxury of walk-in closets and ensuite bathrooms, while the kitchens, equipped with high quality European appliances, effortlessly blend function and form. Thoughtfully designed, service amenities and staff entrances are discreetly hidden away, preserving a sense of privacy exclusively for you and your guests.









Beyond sliding glass doors lies an elegant sanctuary adorned in sandy hues.

Adjacent, a welcoming lounge area is a space to host meetings or bask in relaxation.





A large, built-in wooden bookshelf system with a desk and a white leather chair. The shelves are filled with books, including titles like "LE VIGILANTE" and "Alvar Aalto". The desk is a light-colored wood with a white leather chair. The room is illuminated by recessed ceiling lights and a desk lamp.

A light-colored wooden desk with a white leather chair. The desk is positioned in front of the bookshelf. The chair is a modern, white leather office chair with a five-point base and casters.

A large, round, textured ottoman in the foreground. It has a dark wood base and a light-colored, textured fabric top. It is positioned on a grey carpet.

Decorative items on the bookshelf include a glass lamp, a vase, a sculpture of two figures, and a small wooden box. The shelves are filled with books, including titles like "LE VIGILANTE" and "Alvar Aalto".

A wall with horizontal wooden slats, possibly a partition or a decorative wall element. It is located on the left side of the room.

A window with light-colored curtains on the right side of the room. The curtains are partially drawn, allowing natural light to enter.

Recessed ceiling lights and a desk lamp. The desk lamp is a modern, white leather lamp with a glass shade. The recessed ceiling lights are arranged in a grid pattern.

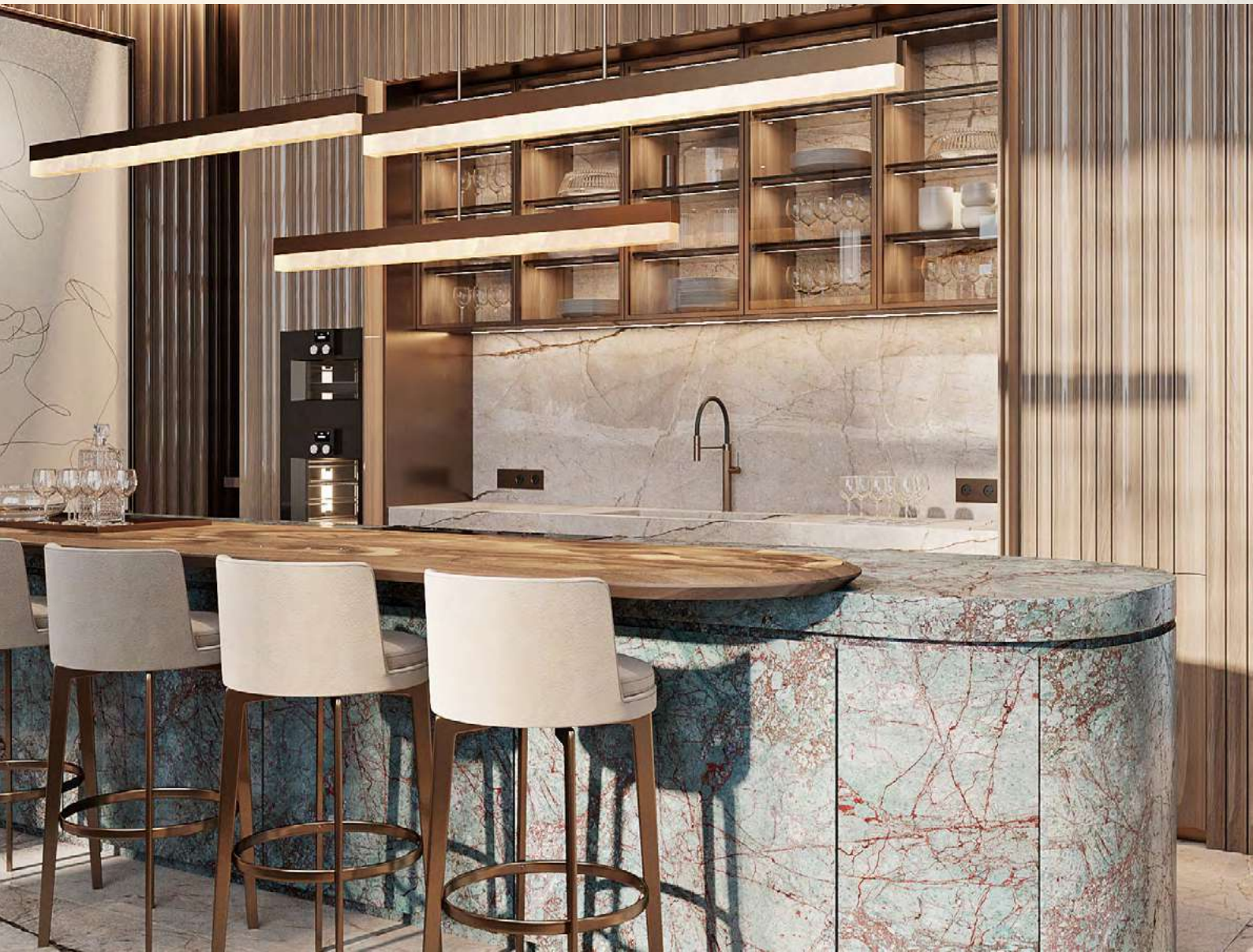

The kitchen features walnut wood panels with a glossy lacquer finish, blending both sophistication and nature-inspired aesthetics seamlessly.

In the dining area, elegance meets comfort. The space softly casts a warm and inviting glow, inviting memorable gatherings and conversations.







Visible right upon entry is the expansive master bedroom and dressing room. The panoramic cityscape unfolds from this point.







YODEZEEN envisioned the master bathroom in warm pinkish marble, accentuated with a delicate pattern.

The bathroom offers dual passageways sans doors, showcasing an innovative design approach.











INFINITE
LUXURY
LIVING



RESIDENCES THAT STAND ABOVE

Perfectly positioned, ORLA Infinity offers captivating vistas of the serene Gulf waters that unfold from within your exquisitely crafted residence.

The magnificence of this view extends beyond the soft curved terrace, a rarity in Dubai, revealing an impressive panorama that embraces the landscaped grounds of Palm Jumeirah, and the breathtaking skyline of Dubai.



CURVED TERRACES
AND FLOWING INFINITY POOLS

An aerial, top-down view of a modern building's terrace. The terrace is paved with light-colored stone tiles and features a large, rectangular swimming pool with rounded corners. The pool is surrounded by a light-colored concrete deck. To the left of the pool, there is a lounge area with a white sofa, a coffee table, and a large green tree. To the right of the pool, there is a curved walkway that meanders at water level. The building's glass facade is visible on the left side of the image, showing the interior of the terrace. The overall scene is bright and sunny, with shadows cast by the furniture and the tree.

Gracefully adorning each terrace, private pools spanning up to 18 metres in length, and up to 3 metres in width, invite indulgent relaxation.

At the outermost point of the balcony, a tranquil walkway meanders at water level, providing an enchanting retreat to bask in the splendor of the magnificent views.



SURROUNDED BY
CAPTIVATING BEAUTY



A WORLD WHERE
EVERY DETAIL IS FINESSED



AT THE PINNACLE
OF PALM JUMEIRAH

A modern lounge interior with brown leather seating, wood-paneled walls, and ambient lighting. The room features a dark, textured ceiling with recessed lighting and a long, narrow table in the foreground. The overall atmosphere is sophisticated and contemporary.

AMENITIES
ELEVATED



WHERE WATER, LIGHT AND SUN EMBRACE YOUR SERENE SPACE

As an ORLA Infinity resident, exclusive access is granted to all ORLA's world-class amenities. Here is where wellbeing and enjoyment take center stage, creating an experience that complements the splendor of your surroundings.

Descend into the ORLA grounds and get swept away by the best aspects of the amenities. From captivating recreational spaces to serene retreats, ORLA's and ORLA Infinity's amenities redefine relaxation,

excitement, and sophistication. Find exclusive escapes from a resident only beach club, two private cinemas, sophisticated cigar lounges, indoor kid areas, and bowling and entertainment lounges throughout.



Relish in the private beach of ORLA and ORLA Infinity, where untouched sands of Palm Jumeirah and the glistening crystal waters clasp at your senses. Experience the luxury of having a pristine paradise just steps from your residence.

Take time to unwind in the spa, rejuvenate in our serene treatment rooms, and relax in the pools, all designed with your wellbeing in mind.



ORLA BEACH CLUB

Presenting ORLA's exclusive beach club, reserved exclusively for ORLA and ORLA Infinity residents, situated along the pristine shores of Palm Jumeirah and the crystal waters of the Arabian Gulf.

Proudly placed next to the beach club is a magnificent infinity pool, accompanied by comfortable sun loungers and luxurious cabanas, where you can relax and enjoy poolside dining with

family and friends. Spend your day sipping refreshing cocktails and savor the culinary delights while immersing yourself in the serene ambiance of ORLA, leaving the city noise behind.



RESIDENT ONLY BEACH CLUB



SUNSET LOUNGE



INDOOR TEMPERATURE
CONTROLLED LAP POOL



STATE-OF-THE-ART
CYCLING STUDIO



DUBAI'S FIRST RESIDENT ONLY
CIGAR LOUNGE



PRIVATE CINEMA



ANTICIPATING
YOUR NEEDS



Managed by

Dorchester Collection

Dorchester Collection, renowned for their unwavering commitment to meticulous attention to detail and exceptional service, caters to the discerning individuals.

ORLA Infinity, managed exclusively by Dorchester Collection, continues this legacy of excellence. Residents can anticipate the highest level of attentive service, reflecting the exceptional standards with Dorchester Collection's iconic hotels worldwide.

À La Carte

- Housekeeping
- Laundry
- Maintenance
- Bespoke in-residence catering services
- One-off dining events & functions
- Floristry services
- Bookings, reservations & appointments
- Five-star experiences at home

Classic

- Common area maintenance and cleaning
- 24/7 Residence concierge
- Doorman and porter services
- Valet parking
- Lifeguard and gym service
- 24/7 Security services



THE HEIGHT OF REFINED LIVING

The essence of ORLA and ORLA Infinity, Dorchester Collection, Dubai, lies in the art of refined luxury living. Be a part of a world that envelops you in beauty, sophistication, and exclusive privileges.

From intricate design elements to impressive outdoor spaces, every detail has been thoughtfully crafted to inspire connection, relaxation, and the creation of cherished memories.

OMNIYAT THE ART OF ELEVATION

OMNIYAT is a renowned developer of architectural masterpieces. The Art of Elevation embodies our dedication to imagining the extraordinary and building it into reality. We create immersive living masterpieces framed by Dubai's iconic skylines.



Since our establishment in 2005, OMNIYAT has redefined each project as an extraordinary, rare piece of art, partnering with global pioneers such as Foster + Partners, Zaha Hadid, Gilles et Boissier, Dorchester Collection and more.

The OMNIYAT touch lies in our ability to enhance experiences and shape the future of luxury living.