

U N V E I L

Y O U R

E X Q U I S I T E

S A N C T U A R Y

 **SYMBOLIC ALPHA**



SYMBOLICTM
BUILDING HOMES. CREATING LEGACIES.

Division of **SPEEDEXGROUP**

B U I L D I N G
A L E G A C Y . . .
T R A N S F O R M I N G
T H E F U T U R E

Speedex Group, a Dubai-based conglomerate, has been shaping the wholesale and retail industry since 1991. From a small hardware store, it grew into one of the leading import and export businesses in the UAE. The company expanded into DIY retail, advanced agriculture, and boutique real estate development.

Explore a world where innovation, sustainability, and quality intersect. Speedex Group's unwavering commitment to empowering communities and their relentless pursuit of excellence make them a trailblazer in the UAE's wholesale and retail industry. Embrace their values and join them on the journey toward a brighter future.

S Y M B O L I C

A L P H A

Welcome to Symbolic Alpha, a modern residential community that redefines comfortable living. Discover our exclusively designed 1 BHK and 2.5 BHK apartments, ideal for families and young professionals seeking upscale living. At Symbolic Alpha, we prioritize our residents' needs and quality of life. Inspired by beehives, our development features amenities promoting relaxation, wellness, and social interaction. Our standout feature, a temperature-controlled swimming pool, offers refreshing dips on hot summer days. Experience our yoga garden, EV charging station, and energy-efficient appliances, minimizing our environmental impact. Embrace a harmonious and sustainable lifestyle at Symbolic Alpha.





O U R L O C A T I O N

Welcome to a remarkable property situated in a prime location, marked by its desirable address at LIWAAN. Nestled in this sought-after neighborhood, this property offers an extraordinary opportunity to indulge in a lifestyle that seamlessly combines convenience, beauty, and tranquility.



L I W A N A T T R A C T I O N S

M A L L S

Silicon Central Mall	06 Mins
Dubai Outlet Mall	09 Mins
Cedre Shopping Centre	12 Mins
Dubai Mall	15 Mins
Mirdif City Centre	16 Mins

S C H O O L S

British Orchard Nursery	03 Mins
Gems WSO	10 Mins
Toddlers International Nursery	11 Mins

M O T O R W A Y S

Sheikh Mohammed Bin Zayed Road	08 Mins
Dubai-Al Ain Road	09 Mins
Emirates Road	10 Mins
Sheikh Zayed Road	15 Mins

M E D I C A L

C O M M U N I T Y

Medicure Polyclinic Silicon Oasis	10 Mins
Nad Al Sheba Health Cente	17 Mins
HMS Mirdif Hospital	18 Mins

A T T R A C T I O N S

IMG World	09 Mins
Global Village	15 Mins
Dubai Miracle Garden	15 Mins
Burj Khalifa	16 Mins
Museum of The Future	17 Mins

C O M M U N I T Y

P A R K S

Liwan Lake Garden	03 Mins
Mazaya Residents Park North	03 Mins
Silicon Oasis Community Parks	10 Mins

A I R P O R T S

Dubai International Airport	18 Mins
Al Maktoum International Airport (DWC)	25 Mins
Sharjah International Airport	29 Mins

A S U B T L E
F A C A D E T H A T
E M B R A C E S
S I M P L I C I T Y





A W E - I N S P I R I N G
A R R I V A L



S O C I A L I Z E

W I T H

F L A I R

Step into a world of grandeur where every detail is meticulously crafted. From the luminous, inviting living rooms that exude warmth and comfort to the captivating, imaginative spaces that inspire creativity and escape, our luxurious offerings redefine extravagance.







C R A F T E D

F O R

Y O U R

C O M F O R T

Discover our thoughtfully designed 1 BHK and 2.5 BHK apartments, tailored to meet your needs. Impeccable fixtures and meticulous attention to detail create stylish and functional living spaces. Embrace community living with vibrant communal areas fostering connection and inclusivity.







D E T E R M I N E D
T O C R E A T E
A S U S T A I N A B L E
L E G A C Y

Your gateway to a sustainable world.

Symbolic developments is committed to a sustainable future. Our buildings incorporate renewable energy, sustainable materials, and water-conserving designs. We prioritize waste reduction and recycling while continually assessing our environmental impact. As responsible corporate citizens, we embrace our duty to the planet and future generations. Sustainability is at the core of our vision. Join us in shaping a brighter tomorrow, where every brick carries the essence of responsible stewardship.



I M M E R S E I N
B L I S S ,
S Y M B O L I C '
T E M P E R A T U R E
H A V E N

Imagine gliding through crystal-clear waters, caressed by the perfect temperature that remains blissfully constant, inviting you for a refreshing dip no matter the season. Feel the gentle embrace of the water as you embark on a leisurely swim or power through invigorating laps to keep your body and mind in perfect harmony.



• Temperature-Controlled Swimming Pool



• Jogging Track

S T R I D E
I N
S T Y L E

Nestled amidst verdant landscapes and breathtaking scenery, our track invites you to stroll or sprint, immersing yourself in nature's embrace. Tailored to accommodate beginners and seasoned athletes alike, it's the ultimate haven for daily workouts and invigorating breezes.



• Yoga & Meditation

N U R T U R E

Y O U R

I N N E R

Z E N

Awaken Serenity in our Sacred Yoga & Meditation Garden. Embrace nature's embrace, embark on a transformative journey to rejuvenate mind, body, and spirit.

L I T T L E

S P L A S H E R S'

P A R A D I S E

A separate kid's pool, located next to our main swimming pool, with shallow depths and fun water play equipment. Parents can relax while their little ones create unforgettable memories in a fun and safe environment.



• Kids Pool



• Jacuzzi

J E T S

O F

J O Y

Escape the strains of everyday life as you immerse yourself in this therapeutic retreat. Whether you seek relief for tired muscles or crave a blissful social gathering, our jacuzzi is the idyllic destination to find repose and rejuvenation.

R E J U V I N A T E

Y O U R

B O D Y

Elevate your fitness at our state-of-the-art Health Club designed for all residents. With a mixed gender gym, premium equipment, a serene sauna, and convenient lockers, it's the ideal place to stay healthy. Enjoy shared amenities like showers, and changing rooms, ensuring a comfortable and enjoyable workout experience for everyone.

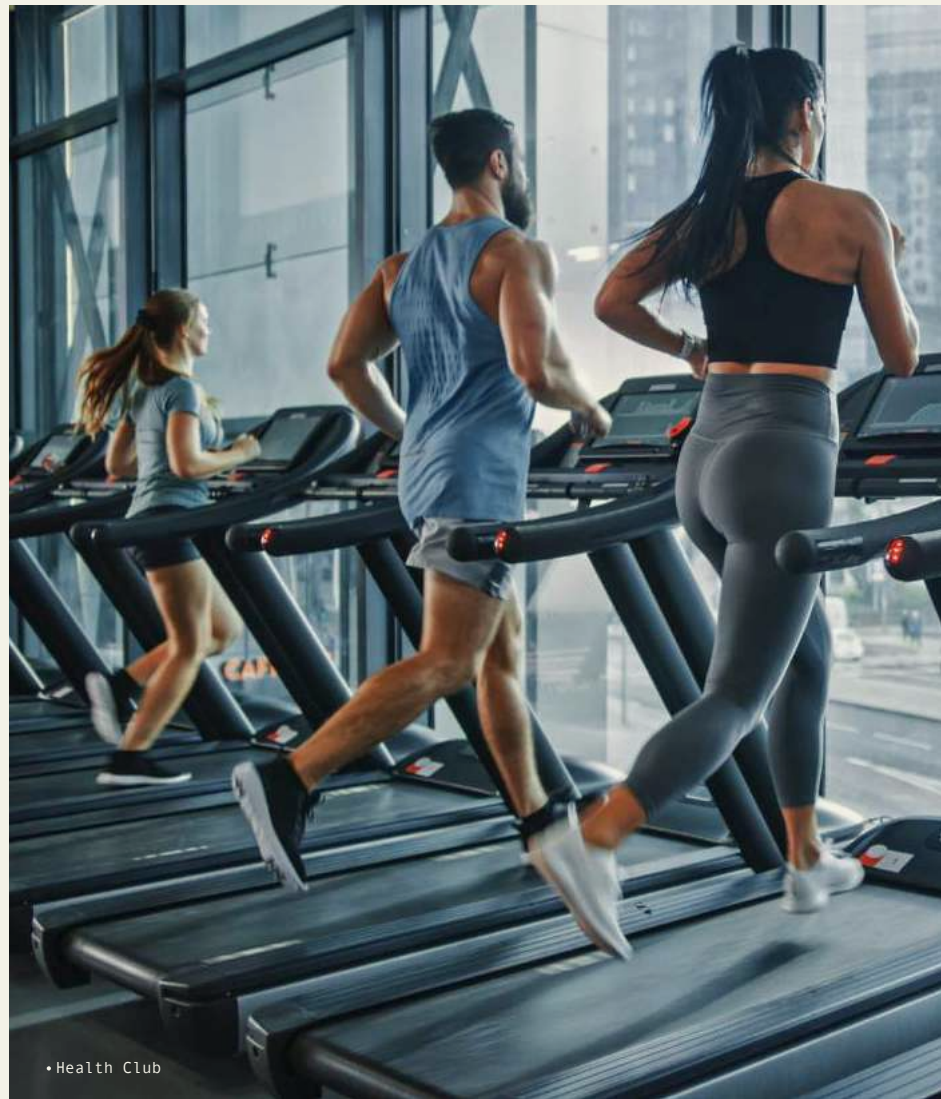

• Health Club



•Landscape Garden and Outdoor seating Area

W H I S P E R S

O F P E A C E

Relax beneath shady trees, find solace in a book, or cherish heartfelt conversations on inviting outdoor benches. Revel in the breathtaking beauty of our landscape garden.

E M B R A C E

T H E

E L E C T R I C

R E V O L U T I O N

At Symbolic Alpha, we go the extra mile with electric vehicle charging stations. Encouraging ecoconscious living, conveniently located on-site for residents to charge their cars. Join us in reducing our carbon footprint and embracing a cleaner, greener future.



•EV Charging station



F I R E
U P
T H E
F L A V O R

Savor unforgettable outdoor feasts in our vibrant BBQ haven. Gather with friends and family, indulge in culinary adventures, and create cherished memories in our picturesque, inviting space.

•BBQ Area

F O S T E R I N G
C H I L D H O O D
J O Y

Experience boundless play at our safe and engaging kids area. Discover a wonderland designed to nurture growth and laughter. With swings, slides, climbing frames, and ample seating, it's a sanctuary for quality family moments, creating cherished memories that will last a lifetime.



•Kids Play Area

FLOOR PLAN

TYPICAL FLOOR PLAN (1ST - 8TH FLOOR)

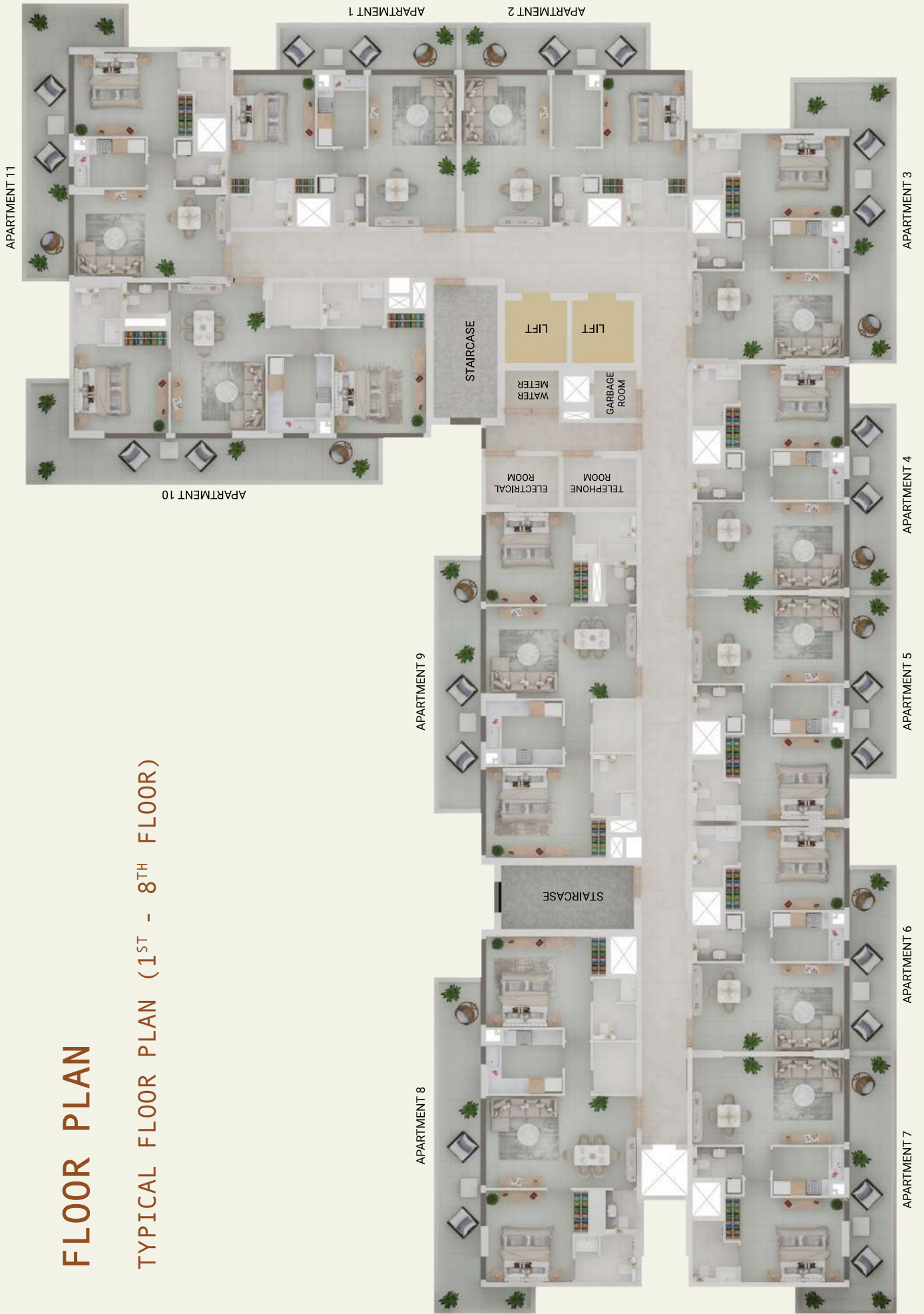

* Disclaimer: All design, features, amenities, materials, dimensions, layout drawings are approximate and subject to change without notice; Actual area of the Unit may vary from the stated area, drawings not to scale; Developer reserves the right to make revisions to comply with any Applicable Law or the requirements of any Relevant Authority; For actual sizes please refer the Unit's Sales Purchase Agreement.

APARTMENT 01



Type 1 - 1 BHK			
TYPE	Suite (Sq. ft)	Balcony (Sq. ft)	Total (Sq. ft)
AREA	574.37	141.44	715.81
APT NO.	P01.101, 201, 301, 401, 501, 601, 701, 801		

Service Shaft

APARTMENT 02



Type 2 - 1 BHK			
TYPE	Suite (Sq. ft)	Balcony (Sq. ft)	Total (Sq. ft)
AREA	574.37	141.44	715.81
APT NO.	P02.102, 202, 302, 402, 502, 602, 702, 802		

Service Shaft

APARTMENT 03



Type 3 - 1 BHK			
TYPE	Suite (Sq. ft)	Balcony (Sq. ft)	Total (Sq. ft)
AREA	574.37	246.93	821.29
APT NO.	P03, 103, 203, 303, 403, 503, 603, 703, 803		
	<input checked="" type="checkbox"/> Service Shaft		

APARTMENT 04



Type 4 - 1 BHK

TYPE	Suite (Sq. ft)	Balcony (Sq. ft)	Total (Sq. ft)
AREA	574.37	141.44	715.81
APT NO.	P04, 104, 204, 304, 404, 504, 604, 704, 804		

Service Shaft

APARTMENT 05

ENTRANCE



Type 5 - 1 BHK			
TYPE	Suite (Sq. ft)	Balcony (Sq. ft)	Total (Sq. ft)
AREA	574.37	141.44	715.81
APT NO.	P05, 105, 205, 305, 405, 505, 605, 705, 805		

Service Shaft

APARTMENT 06



Type 6 - 1 BHK			
TYPE	Suite (Sq. ft)	Balcony (Sq. ft)	Total (Sq. ft)
AREA	574.37	141.44	715.81
APT NO.	P06, 106, 206, 306, 406, 506, 606, 706, 806		
	<input checked="" type="checkbox"/> Service Shaft		

APARTMENT 07

Type 7 - 1 BHK			
TYPE	Suite (Sq. ft)	Balcony (Sq. ft)	Total (Sq. ft)
AREA	574.37	216.25	790.62
APT NO.	P07, 107, 207, 307, 407, 507, 607, 707, 807		

Service Shaft



APARTMENT 08



ENTRANCE

Type 1 - 2 BHK			
TYPE	Suite (Sq. ft)	Balcony (Sq. ft)	Total (Sq. ft)
AREA	870.48	271.04	1141.52
APT NO.	108, 208, 308, 408, 508, 608, 708, 808		

Service Shaft

APARTMENT 09



Type 2 - 2 BHK			
TYPE	Suite (Sq. ft)	Balcony (Sq. ft)	Total (Sq. ft)
AREA	871.24	193.21	1064.45
APT NO.	P08, 109, 209, 309, 409, 509, 609, 709, 809		

Service Shaft

APARTMENT 10



Type 3 - 2 BHK			
TYPE	Suite (Sq. ft)	Balcony (Sq. ft)	Total (Sq. ft)
AREA	886.85	308.5	1195.34
APT NO.	P09, 110, 210, 310, 410, 510, 610, 710, 810		

Service Shaft

APARTMENT 11



Type 8 - 1 BHK			
TYPE	Suite (Sq. ft)	Balacony (Sq. ft)	Total (Sq. ft)
AREA	574.37	234.66	809.02
APT NO.	P10, 111, 211, 311, 411, 511, 611, 711, 811		

Service Shaft



127, Sheikh Zayed Road- Al Quoz 3 - Dubai, UAE P.O. Box 13460
www.symboli.ae | info@symbolic.ae | +97143212025 | Toll-Free 800 5300

PROJECT RERA ID : 2668

Follow us on / symbolicuae

